

290430 FENDER ASSEMBLY INSTRUCTIONS FOR FAT-TAD & E-FAT-TAD

Part List

A	Front Fender Front	2 PCS
B	Fender Strut Rear	2 PCS
C	Fender	1 PC
D	Rear Fender Strut 1	1 PC
E	Rear Fender Strut 2	1 PC
F	M5 x 12mm Bolt	6 PCS
G	M5 x 5mm Nylock Nut	6 PCS
H	M6 x 10mm Screw	2 PCS
I	M5 x 10mm Screw	5 PCS
J	M5 x 16mm Screw	2 PCS
K	M5 x 12mm Washer	5 PCS

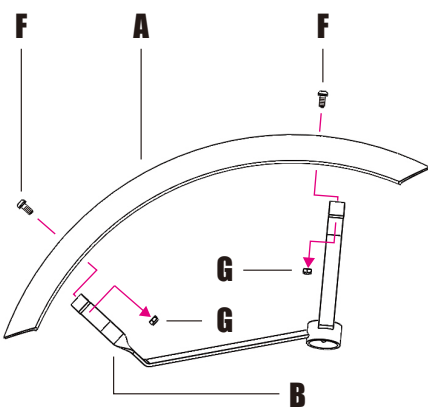
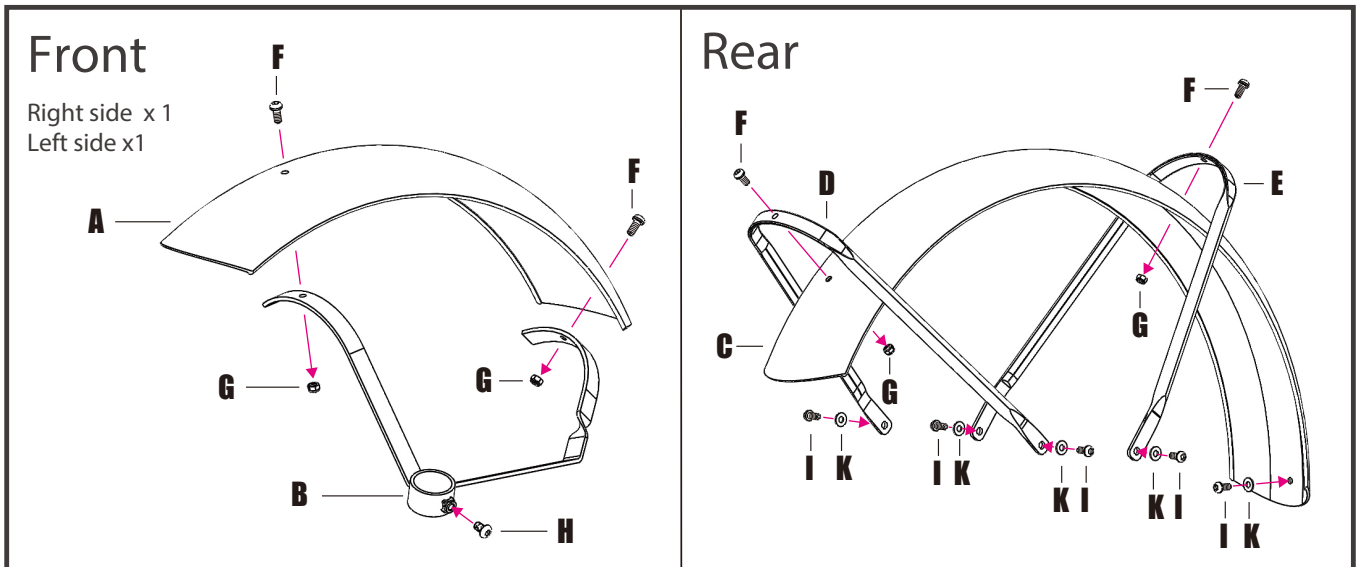

STEP 1.

Install fender strut (B) onto the front fender (A) tighten bolt (F) and nylock nuts (G).

NOTE: L & R sides are symmetrical direction.

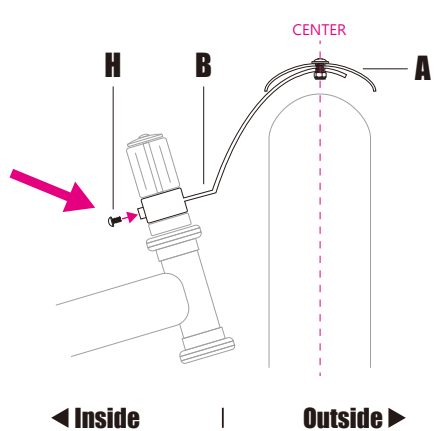

STEP 2.

Install the front fender (A) onto the steer tube and insert the ring of fender strut (B) in place of 2nd spacer and then using the set screw (H) align fender and tighten.

NOTE: same procedure on both left and right front fenders.

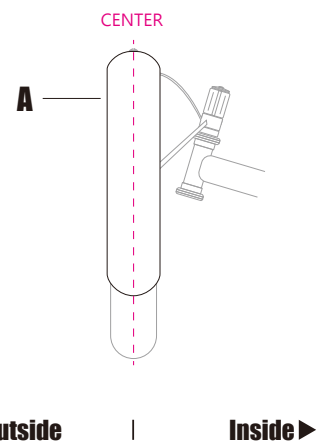

STEP 3.

Finish assembly on both sides. Adjust the fenders to be in the center position and make sure there is no fender interference when the tire rotates, as shown.

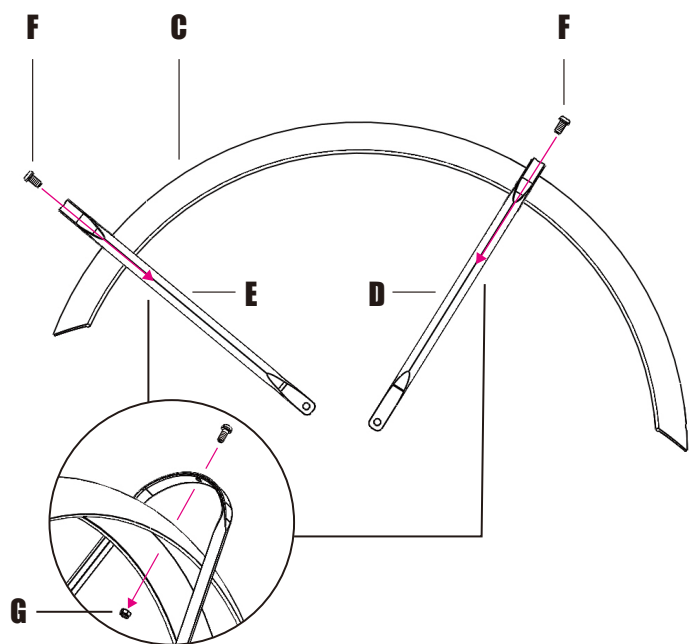

STEP 4.

Install fender strut-1 (D) and fender strut-2 (E) onto the rear fender (C) tighten bolts (F) and nylock nuts (G).

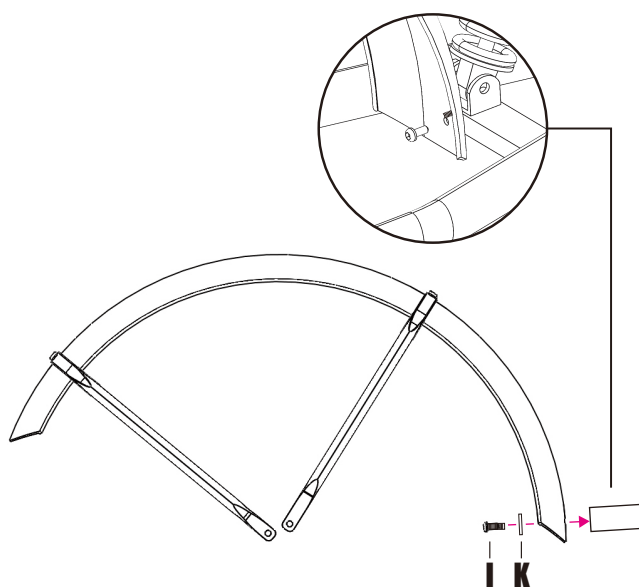

STEP 5.

Installing the rear fender (C) onto the end of frame using screw (I) and washer (K) tighten.

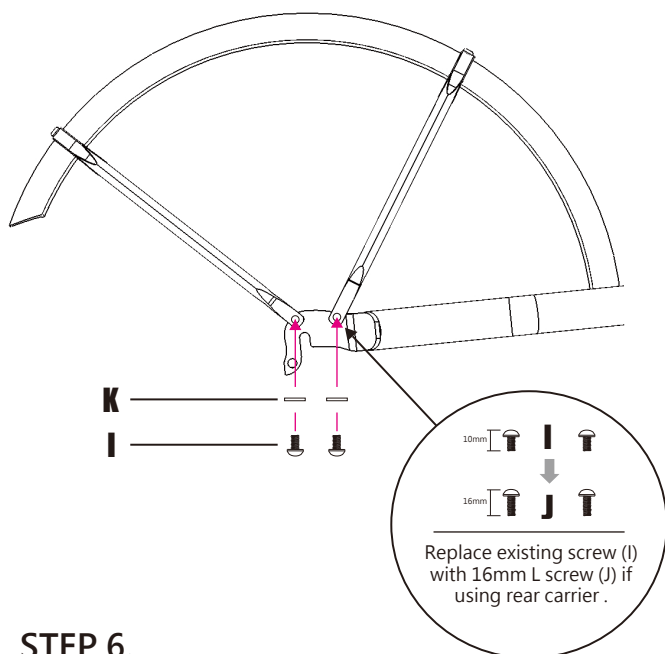

STEP 6.

Install fender struts (D) and (E) onto the frame dropout and secure with screw (I) and washer (K). Repeat for other side.

NOTE: when using with rear carrier , replace the existing screw (I) with longer screw (J), as shown.

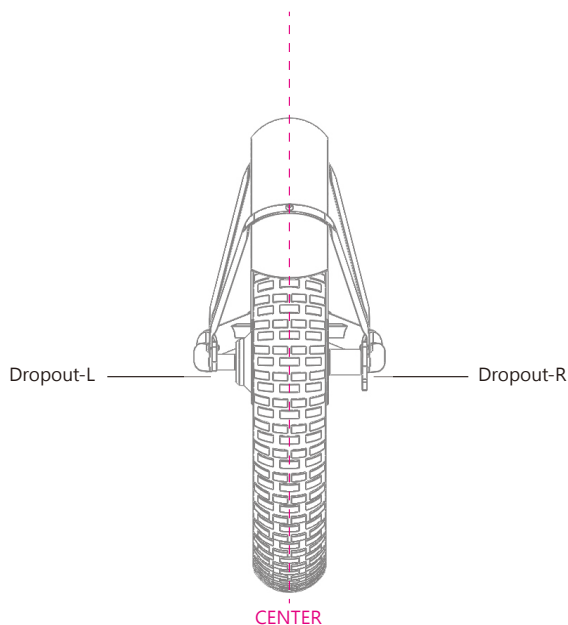

STEP 7.

Finish assembly. Adjust the fender to be in the center position and make sure there is no fender interference when the tire rotates, as shown.